

MR16

LED LAMP



The MR16 LED is an innovative sunken LED lamp made with 3 x 1W LEDs featuring a very high luminous efficiency.

The LED technology used in the MR16 LED lamp gives a variety of advantages:

- Limited heat emission.
- Zero emission of ultraviolet and infrared radiation.
- A very long lifespan (over 60,000 hours).
- Low running costs (less than one tenth of a conventional lamp).

The MR16 LED is available in 3 models:

MR16 RGB

The MR16 RGB features three 1W LEDs (1 red, 1 green, 1 blue) and can be utilized as a RGB colour changer, using the D.T.S. power supply / DMX-512 LED driver; 1 single power supply / DMX-512 LED driver can manage up to 12 MR16 RGB lamps. Connecting the LED lamps to the driver is fast and easy, thanks to the dedicated T-BOX RJ12 connection system.

The MR16 RGB connected to the D.T.S. power supply / DMX-512 LED driver can be controlled either via an optional infra-red remote control, a recessed wall controller, or any DMX lighting console.

MR16 WHITE / MR16 WARM WHITE

The MR16 WHITE and MR16 WARM WHITE feature three 1W white LEDs. The MR16 WHITE has a 5.500°K colour temperature.

The MR16 WARM WHITE has a 3.200°K colour temperature.

Both models can be powered by a 12V DC power supply.

LAMPS / CODES

MR16 RGB 8° (Code 0505L004)

MR16 RGB 25° (Code 0505L005)

MR16 RGB 40° (Code 0505L006)

MR16 WHITE 8° (Code 0505L001)

MR16 WHITE 25° (Code 0505L002)

MR16 WHITE 40° (Code 0505L003)

MR16 WARM WHITE 8° (Code 0505L009)

MR16 WARM WHITE 25° (Code 0505L010)

MR16 WARM WHITE 40° (Code 0505L011)



The Lighting Company



MR16 LED LAMP

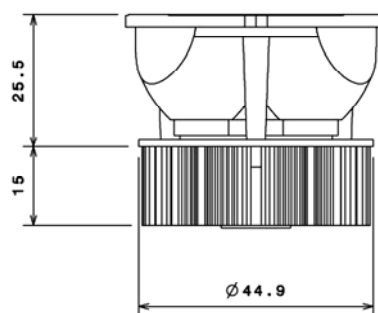
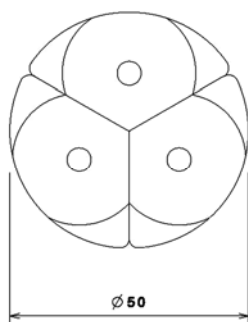

Interchangeable lenses

3 interchangeable lenses (Narrow, Medium Flood, Wide Flood) are available for the 3 models, offering different projection angles for light beams. Light emission is spread uniformly and without spots, with excellent homogeneity of surface coverage.

Photometric charts

		MR16 RGB			MR16 White			MR16 Warm White		
		mt 1	mt 2	mt 3	mt 1	mt 2	mt 3	mt 1	mt 2	mt 3
Narrow lenses	Lux center	2000	570	260	1250	318	153	760	200	92
	Diameter cm	14	28	42	14	28	42	14	28	42
Medium flood lenses	Lux center	300	80	33	500	121	55	230	64	28
	Diameter cm	44	88	133	44	88	133	44	88	133
Wide flood lenses	Lux center	110	28	12	180	46	22	90	22	10
	Diameter cm	73	146	218	73	146	218	73	146	218

Dedicated flanges (A: adjustable / F: fixed)



CHROME LUX
(A Code 03.F009.06)
(F Code 03.F010.06)

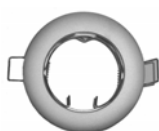

GOLD LUX
(A Code 03.F009.09)
(F Code 03.F010.09)



BRUSHED STEEL
(A Code 03.F009.11)
(F Code 03.F010.11)



NICKEL PEARL
(A Code 03.F009.13)
(F Code 03.F010.13)



CHROME PEARL
(A Code 03.F009.30)
(F Code 03.F010.30)



WHITE
(A Code 03.F009.03)
(F Code 03.F010.03)



BLACK
(A Code 03.F009.01)
(F Code 03.F010.01)

Accessories



**T-BOX RJ12
CONNECTION SYSTEM**
(Code 03.LA.001)



**POWER SUPPLY /
DMX-512 LED DRIVER**
(Code 03.LA.002)



WALL CONTROLLER
(Code 0514L007)



REMOTE CONTROL
(Code 0514L005)
INFRA-RED SENSOR
(Code 0514L006)

PAR 16 LED



Besides being recessed in walls and furniture, the MR16 LED is also available as PAR 16 LED, offering both the benefits of the LED light source and the flexibility of a compact Par 16 par can.

PAR 16 LED LUX
(Code 03.P16.02.02.LED)
PAR 16 LED LUX
(Code 03.P16.02.01.LED)



D.T.S. products are designed and manufactured at the D.T.S. plants in Italy

D.T.S. Illuminazione s.r.l. _ via Fagnano Selve, 10/12/14 _ 47843 Misano Adriatico (RN) Italy
Tel. +39 0541 961131 _ Fax +39 0541 611111 _ e-mail: info@dts-lighting.it _ http: www.dts-lighting.it

The Lighting Company